

▶▶▶▶ User Manual

Apollo[®]-6205

OTC Hearing Aid



 **HearingHelp** *express*
an Intricon company

1-800-221-2099 • HearingHelp.com

Safety and health information

WARNING: If you are younger than 18, do not use this.

You should go to a doctor, preferably an ear-nose-throat doctor (an ENT), because your condition needs specialized care. Over-the-counter hearing aids are only for users who are age 18 or older.

This OTC hearing aid is for users who are 18 and older. People who are younger than 18 with hearing loss should see a doctor, preferably an ENT, because they may need medical testing and management. Hearing loss can affect speech and learning, so professional fitting and continuing care are also important.

WARNING: When to see a Doctor

If you have any of the problems listed below, please see a doctor, preferably an ear-nose-throat doctor (an ENT).

- Your ear has a birth defect or an unusual shape. Your ear was injured or deformed in an accident.
- You saw blood, pus, or fluid coming out of your ear in the past 6 months
- Your ear feels painful or uncomfortable
- You have a lot of ear wax, or you think something could be in your ear
- You get really dizzy or have a feeling of spinning or swaying (called vertigo)
- Your hearing changed suddenly in the past 6 months
- Your hearing changes: it gets worse then gets better again
- You have worse hearing in one ear
- You hear ringing or buzzing in only one ear

WARNING: This hearing aid should not cause pain when inserting it.

Remove this device from your ear if it causes pain or discomfort when you insert or place it. To try again, make sure to follow the instructions. If you feel pain or discomfort again, contact the manufacturer. If your pain or discomfort doesn't go away, contact your hearing healthcare professional. You can also report this to the FDA as an adverse event according to the instructions that appear later.

Safety and health information

WARNING: Do NOT store or replace batteries near where you store medication or near children.

Battery ingestion can cause serious harm. If you think that you or someone else has swallowed a battery or placed a battery inside any part of the body, seek immediate medical attention. Leaking or exploding batteries result in the creation of harmful substances. If this happens, avoid skin contact with these substances. If there is leakage on skin, eyes, or in the ear, seek medical advice. If there is leakage on the hearing aid, return it to the manufacturer for evaluation.

WARNING: Do NOT resell the hearing aids or share them with others.

They are intended for use by a single user. Using resold or shared hearing aids may lead to infection.

WARNING: Do NOT conduct any of the following, they may cause damage to your hearing aids or accessories.

- Do not immerse your hearing device in water or liquid.
- Do not bend the tube and dome back and forth to remove it.
- Do not use clearing wire while the tube is connected to the hearing device.
- Do not use alcohol on earmold or dome.
- Do not use sharp tools to dislodge ear wax.
- If using prescribed ear drops, remove any moisture that may get into the earmold / tubing.
- Do not wear your hearing device while bathing, showering, swimming, or in a moist atmosphere, like steam baths or sauna.
- If your hearing device gets wet, do not attempt to dry it in an oven or microwave. Do not adjust any controls. Open the battery door immediately and allow your device to dry naturally for 24 hours. Do not use the hearing device until the device is completely dry.

CAUTION: This is not hearing protection.

You should remove this device if you experience overly loud sounds, whether short or long-lasting. If you're in a loud place, you should use the right kind of hearing protection instead of wearing this device. In general, if you would use ear plugs in a loud place, you should remove this device and use ear plugs.

CAUTION: The sound output should not be uncomfortable or painful.

You should turn down the volume or remove the device if the sound output is uncomfortably loud or painful. If you consistently need to turn the volume down, you may need to further adjust your device.

Safety and health information

CAUTION: You might need medical help if a piece gets stuck in your ear.

If any part of your hearing aid, like the eartip (dome), gets stuck in your ear, and you can't easily remove it with your fingers, get medical help as soon as you can. You should not try to use tweezers or cotton swabs because they can push the part farther into your ear, injuring your eardrum or ear canal, possibly seriously.

Note: If you remain concerned, consult a professional.

If you try this device and continue to struggle with or remain concerned about your hearing, you should consult with a hearing healthcare professional.

Note: What you might expect when you start using a hearing aid.

A hearing aid can benefit many people with hearing loss. However, you should know it will not restore normal hearing, and you may still have some difficulty hearing over noise. Further, a hearing aid will not prevent or improve a medical condition that causes hearing loss.

People who start using hearing aids sometimes need a few weeks to get used to them. Similarly, many people find that training or counseling can help them get more out of their devices.

If you have hearing loss in both ears, you might get more out of using hearing aids in both ears, especially in situations that make you tired from listening—for example, noisy environments.

Note: Tell FDA about injuries, malfunctions, or other adverse events.

To report a problem involving your hearing aid, you should submit information to FDA as soon as possible after the problem. FDA calls them “adverse events,” and they might include: skin irritation in your ear, injury from the device (like cuts or scratches, or burns from an overheated battery), pieces of the device getting stuck in your ear, suddenly worsening hearing loss from using the device, etc.

Instructions for reporting are available at:

<https://www.fda.gov/Safety/MedWatch> or call 1-800-FDA-1088.

You can also download a form to mail to FDA.

Note: Any harm caused by the device or any dissatisfaction using the device must be reported to Hearing Help Express.

Call 1-800-221-2099, email support@hearinghelp.com

or write to: Hearing Help Express, PO Box 586, DeKalb, IL 60115.

Intended Use:

The Apollo®-6205 is an air-conduction hearing aid intended to compensate for impaired hearing for individuals who are 18 years of age and older with perceived mild to moderate hearing loss. This device is intended for use without the assistance of a hearing care professional.



Table of contents

1. Welcome	6
2. Setting up the hearing aids	
What's inside the box	7
Hearing aid overview	8
Inserting the battery / low battery indicator	9
How to wear hearing aids	10
Check the fit for comfort	11
3. Hearing aid controls and programs	
Powering on and off	12
Adjusting the volume control	12
Program control and settings	13
How to use with telephone	13
4. Maintenance and care	
Removing and attaching tubes and domes	14
Daily maintenance	15
Care recommendations	15
5. Troubleshooting and service	16
6. Technical specifications	17
7. Accessories	
Domes, tubes, and maintenance tools	18
Batteries and more	19-21
8. Warranty	
Limited one year warranty	22
Serial number record	23



welcome

to Hearing Help Express® and your Apollo®-6205 OTC Hearing Aid(s)

Congratulations on your choice of the Apollo®-6205 hearing aid to help you on your journey to improved hearing. We're confident you'll enjoy all the benefits the Apollo®-6205 has to offer.

Put your Apollo®-6205 to the test and find out if it's right for you. To help you make the most of your 45 day home trial, we ask that you read the entire user guide before you begin trying your new hearing aid(s). This user guide will provide you with the information needed to properly use and maintain your new Apollo®-6205 OTC hearing aid(s).



For your better hearing.

Your Hearing Support Team

Remember, we're here to help. If you have questions or need help with your Apollo®-6205 hearing aid, call toll-free.

Call: **1-800-221-2099** (Mon - Fri • 7:30 am - 5 pm CT)
or email us at: support@hearinghelp.com



TRUSTED BY **750,000+** CUSTOMERS SINCE 1979

Setting up the hearing aids

What's inside the box

Single Apollo®-6205 hearing aid

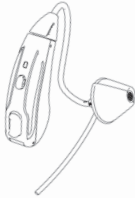

1 Apollo®-6205 hearing aid
with size 1B tube
(Left or Right as ordered)
and tulip dome attached



Left or Right tubes
sizes 0B, 2B (1 ea, qty 2)



Brush & tube clearing wire
(1 ea, qty 2)



Hearing aid storage case
(qty of 1)

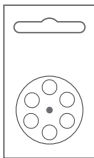

Size #312 batteries
(1 pk of 6 ea, qty 6)



Open and double domes
sizes Sm, Md, Lg (1 ea, qty 6)



User manual (qty 1)

Pair of Apollo®-6205 hearing aids

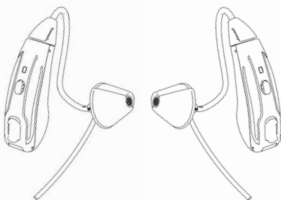

Apollo®-6205 hearing aids
with size 1B tube and tulip
dome attached (1 pair)



Left and Right tubes
sizes 0B, 2B (1 ea, qty 4)



Brush & tube clearing wire
(1 ea, qty 2)

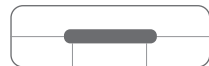

Hearing aid storage case
(qty of 1)

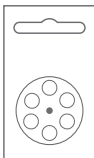

Size #312 batteries
(2 pks of 6 ea, qty 12)



Open and double domes
sizes Sm, Md, Lg (2 ea, qty 12)



User manual (qty 1)

Setting up the hearing aids

Hearing aid overview

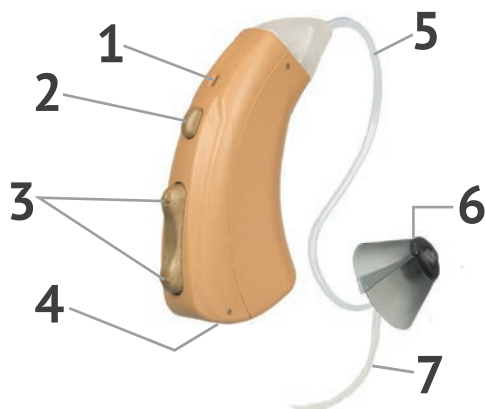

1. Microphone – Sound enters the hearing aid through the microphone.
2. Program button – Press to change program settings.
3. Rocker volume control – Press the toggle up or down to change the volume.
4. Battery door – Battery is inserted here and functions as the on/off switch.
5. Tube – Each hearing aid comes with a size 1B tube attached to the hearing aid receiver nub. Sound travels through the tube into your ear canal.
6. Dome – Each hearing aid comes with a tulip dome attached to the tube.
7. Retention lock – Keeps the dome and tube securely in place.

Serial number: Located on the outer casing of the hearing aid.



Your Apollo®-6205 can be used in either ear by selecting a right tube or a left tube. Each tube is preformed to “point” into either the right or left ear.

Set for left ear. **Set for right ear.**

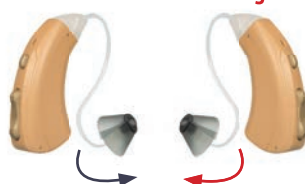

Setting up the hearing aids

Inserting the battery

A size #312 zinc-air hearing aid battery is required for each hearing aid device. Once a battery is replaced, each battery has an expected battery life of approximately 183 hours.

To insert or replace batteries, follow these steps:

Step 1: Remove the tab from the flat, positive (+) side of the size 312 zinc-air battery. Removing this sticker will activate the battery. **Wait one minute for battery to reach full power before placing the battery into the battery door.**



Step 2: Gently open the battery door, using your fingernail or thumbnail. Pull out on the small lip of the battery door located on the lower part of the hearing aid.



Step 3: Locate the positive (+) symbol on the inside top rim of the battery door. This indicates that the flat, positive side of the battery should face up in the same direction as the positive (+) symbol.

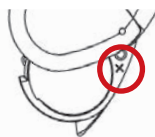

Step 4: Place the battery in the battery door – **NOT** directly inside the hearing aid. Fit the battery in the door with the flat, positive (+) side facing up.

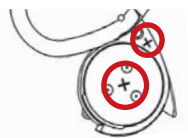

Tip: When inserting the battery, try using the magnet located on the end of the brush.



Step 5: Close the battery door. **NEVER force the battery door closed.** If the door does not close easily, the battery may be upside down.

Low battery indicator

When the battery is no longer strong enough to power your Apollo®-6205, you will hear 2 beeps then a pause then 2 beeps again. This will repeat until you replace the battery.

Setting up the hearing aids

How to wear hearing aids

If you wear eyeglasses, put your glasses on first.

1. With tubing attached to the hearing aid, grasp the tube behind the dome and gently push the dome into your ear canal.

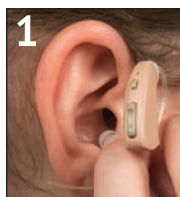

2. Place your Apollo®-6205 over the top of your ear.

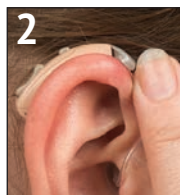

3. Tubing may bulge slightly near the ear canal. Using your fingertip, press gently at the bend in the tubing to ensure proper placement of dome. The tube should fit snugly against your ear.

Tip: The dome should be completely, or almost completely, in the ear canal (the dome will not touch the eardrum). This is key to getting enough loudness and avoid whistling.

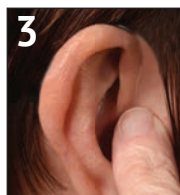

4. Curl and tuck the retention lock along the bowl of your ear.
5. Without applying pressure, slide fingertip up the tube towards the top of the ear, making sure the tube rests against the side of your head.

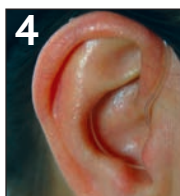

6. The tube should not bulge away from the ear or pull the hearing aid down or the dome out of the ear. If this occurs, try a different length of tube. See pages 11 and 14.

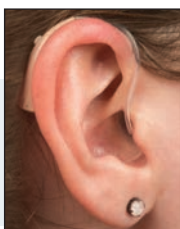

To Remove your hearing aid:

1. Grasp hold of the tube where it rests against your ear and gently pull. The dome will slip out of your ear.
2. Remove the Apollo®-6205 from behind your ear.

ATTENTION: Confirm the dome is attached to the tube each time you remove it from your ear. If the dome remains in your ear, seek medical assistance.

Setting up the hearing aids

Check for fit and comfort

A size 1B tube and tulip dome come attached to each hearing aid. This should be a comfortable fit if:

- The hearing aid rests nicely behind the ear.
- The tube rests against the side of the head without any bulging.
- The dome remains in the ear canal securely.

Included with your hearing aid are additional tubes in size 0B (left and/or right) and size 2B (left and/or right).

Tube size is located close to where the dome is attached.

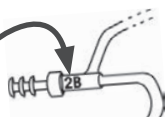

Blue writing on tube = left ear tube size

Red writing on tube = right ear tube size

TUBE MAY BE TOO LONG IF:

1. Tube bulges near the top of the ear.
2. Tube is not resting against the side of your head.
3. Hearing aid will not stay tucked behind the ear.

If the tube is too long, try a shorter size (length) of tube. See page 14.

TUBE MAY BE TOO SHORT IF:

1. Hearing aid pulls forward over the top of the ear and will not stay in place.
2. The hearing aid pulls forward when inserting the dome into the ear canal.
3. Dome keeps falling out of ear canal or does not stay securely in place.

If the tube is too short, try a larger size (length) of tube. See page 14.

Attached to your hearing aid tube is a tulip dome. If you have trouble with the fit of the dome or experience feedback (squeal), try a different dome style (see page 14) included with your hearing aid. Additional fit options are available by calling 1-800-221-2099.



Open dome: Designed with small openings, allowing some natural sound to filter through the ear canal. This can help improve sound quality by allowing lower frequency sounds to dissipate.



Double dome: Provides a full seal around the ear canal, allowing the maximum sound amplification with the least amount of feedback (squeal).



Tulip dome: Designed to be more occlusive than open domes but still keep the ears somewhat “open”, helping to reduce feedback and improve sound quality. Fits a wide variety of ear canal shapes and sizes.



Hearing aid controls and programs

Powering on and off

ON: With a fresh battery installed, fully close the battery door and allow a few seconds for the hearing aid to turn on.



OFF: Open the battery door at least half way to turn your hearing aid off.



It is recommended that you remove the battery when the hearing aid is not in use, keeping the battery door open.

Keep all hearing aid batteries away from children and pets as they are harmful if swallowed. Seek immediate medical attention if a battery is ingested.

Adjusting the volume

Your Apollo®-6205 is equipped with a rocker style volume control that allows you to increase and decrease the volume levels. There are 10 volume levels to choose from.

Increasing the volume: Each time you press the top end of the rocker control, you'll increase one volume level.

Decreasing the volume: Each time you push the bottom end of the rocker control, you'll decrease one volume level.

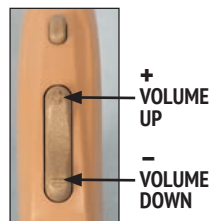

Hearing aid controls and programs

Program control and settings

To select your preferred program setting, press the program button **firmly** then release.

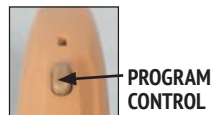

Program 1: Normal setting – You will hear 1 beep.
Use in most listening situations.

Program 2: Noise setting – You will hear 2 beeps.
Reduces the amount of low frequency amplification. Often helpful in noisy situations.

Program 3: Whistle reduction – You will hear 3 beeps.
Use if your Apollo®-6205 whistles or if sounds seem too sharp or tinny.

Talking on the telephone with your Apollo®-6205

You can use your Apollo®-6205 hearing aid while talking on the telephone. Hold the phone close to your hearing aid. You may need to move the phone around a bit until you find where the hearing aid best receives the sound coming from the phone. If you experience feedback (squeal), you may need to tilt the phone at a slight angle.

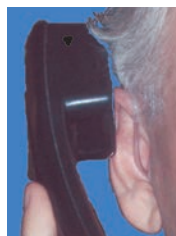

Maintenance and care

How to remove and attach tubes

For optimal performance, tubes should be replaced every 3 months.

To **remove** the tube, follow these steps:

Step 1

Grasp the thicker base of the tube near the top of the Apollo®-6205.



Step 2

Twist the tube 90° to the left or right.



Step 3

Pull the thicker base of the tube away from the aid.



To **attach** the tube:



Line up the top of the hearing aid and the thicker tube base and gently push the end of the tube onto the hearing aid until it snaps into position.

Attention: Make sure the dome and tube are securely attached before using so they do not come off in your ear.

How to remove and attach domes

For optimal performance, domes should be replaced every 3 months.

To **remove** domes:

1. Hold the dome tightly and grasp the tube directly behind the dome. Pull firmly.

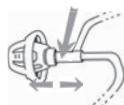

To **attach** domes:

1. Line up the narrow tube nozzle with the opening on the inside of the dome.
2. Push together firmly until the dome is securely attached. Wiggle the dome to be certain it stays in place.

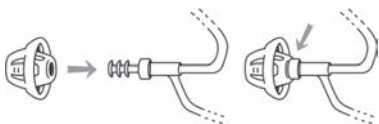

Maintenance and care

Daily maintenance

It's important to keep your hearing aid in good condition. Without regular maintenance, wax and moisture can build up and prevent the hearing aid from working properly. It's best to perform maintenance on your Apollo®-6205 in the morning before you use it.

Maintaining hearing aids:

1. Wipe off the outside of the hearing aid and dome with a soft cloth.
2. Using the brush included with your Apollo®-6205, gently remove wax and dirt from the hearing aid sound openings.

Maintaining tubes:

1. **REMOVE the TUBE** from the hearing aid (see pg. 14).
2. **REMOVE the DOME** from the tube (see pg. 14).
3. Insert the clearing wire into the triangular base at the end of the tube and thread it all the way through so it comes out the other end of the tube.
4. Wipe off any debris on the end of the clearing wire before pulling it back through the tube.



Care recommendations

Follow these instructions to care for and prolong the life of the hearing aids:

- Before storing the hearing aids for extended periods of time, remove batteries and leave the battery door open.
- Hearing aids should be placed into the storage case when not in use.
- Protect hearing aids from extreme hot and cold temperatures.
- Never place your hearing aid in water. If it becomes wet, immediately remove the battery and let your hearing aid stand in a dry place or use a hearing aid dehumidifier (pg. 20) for several hours. NEVER use heat (blowdryer, oven, microwave, etc.) to dry your hearing aid.
- Remove hearing aids before applying hair care products, lotions, creams, perfume, and sprays of any kind.
- Replace domes and tubes every three months.

Troubleshooting and service

Troubleshooting

If your hearing aid is: WHISTLING (FEEDBACK)

1. Your hearing aid may briefly whistle when a hand, hat or other object is near it or when inserting or removing.
2. Turn the volume down, it may be set too high (pg. 12).
3. Check that your dome is inserted correctly (pg. 10).
4. Try a different size dome (pgs. 11 and 14) or call customer service at 1-800-221-2099 for additional fit options.
5. Verify that the tube is attached correctly and is in good condition. If the tube is damaged, it should be replaced (pg. 14).
6. Try a new battery.

If your hearing aid is: WEAK, DISTORTED, DEAD

1. Check that the battery is inserted correctly (pg. 9).
2. Try a new battery.
3. Perform maintenance on your hearing aid, microphone ports, tubing and dome (pg. 15).
4. If your hearing aid goes dead periodically, but comes on after several hours of rest, the problem may be a build-up of humidity. Open the battery door and allow it to air dry or store it in a hearing aid dehumidifier (pg. 20).

Service

If your hearing aid requires service, send it to:

Hearing Help Express • PO Box 586 • DeKalb, IL 60115

1. Call 1-800-221-2099 for authorization before returning your hearing aid for service.
2. Enclose a note with your name, address, phone number and a description of what is wrong with your hearing aid.
3. Remove the battery from your hearing aid. Pack your hearing aid securely in a sturdy box. Do not mail your hearing aid in an envelope, it could be destroyed during shipment. We recommend insured mail for your protection.

Technical specifications

ANSI S3.22 2014 (R2020) / ANSI CTA 2051 2017 (2cc)	
Maximum output limit value Output Sound Pressure Level 90 (OSPL90)	117 dB SPL
Full-on gain value	33 dB
Total Harmonic Distortion (500 Hz)	< 5%
Self-generated noise value	28 dB SPL
Latency value	< 15 ms
Upper and lower cutoff frequencies for (standard) bandwidth	200 Hz – 6000 Hz
Battery size (zinc-air hearing aid battery)	312
Battery current drain	.90 mA
Expected battery life	183 hours



Accessories

Try any Hearing Help Express accessory for 30 days risk-free. If you're not 100% satisfied, return all materials within 30 days from the date of delivery, and we'll refund 100% of your purchase price.

Domes



Tulip Dome

One size#89115



Open Dome

Small#86251

Medium.....#86252

Large#86253



Double Dome

Small#86231

Medium.....#86232

Large#86233



Closed Dome

Small#89121

Medium.....#89122

Large#89123

Tubes

Tube size is located close to where the dome is attached.

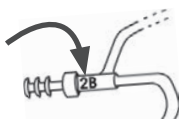

Blue writing on tube = **left** ear tubing size

Red writing on tube = **right** ear tubing size

Left ear tube

0B Left.....#86280

1B Left.....#86281

2B Left.....#86282

3B Left.....#86283

Right ear tube

0B Right.....#86285

1B Right.....#86286

2B Right.....#86287

3B Right.....#86288

Maintenance tools

Brush with battery magnet#88873

Tube clearing wire.....#88871



For pricing or to order accessories

call 1-800-221-2099 or visit www.HearingHelp.com

Hearing aid batteries

Your Apollo®-6205 uses a **size 312 (brown) zinc-air battery**.

Hearing Help Express offers a variety of premium battery brands available in all sizes and various quantities.

Long-Lasting Power • Guaranteed Fresh • Great Low Prices



Eco-Gold MAX

REGULAR TABS

Budget friendly favorite



powerone

LONGER TABS

Easier to handle



RAYOVAC

REGULAR TABS

Trusted brand since 1930



For pricing or to order accessories

call 1-800-221-2099 or visit www.HearingHelp.com

Accessories

Battery testers



Put your mind at ease... test your hearing aid battery and you'll know for sure if it has enough power to run your hearing aid. Simply place your battery in the appropriate size slot, squeeze the blue bar and color coding indicates the remaining power.

Activair Battery Tester.....#88776

This pocket battery tester is small enough to go with you anywhere. This digital tester takes the guesswork out of battery testing. Includes key chain and built-in battery holder compartment.

Key Chain Battery Tester.....#88778



Hearing aid dehumidifiers



Remove harmful moisture from your hearing aid with the Best Value DryAid dehumidifier. Even a little moisture can attack sensitive electronics in hearing aids and needlessly shorten their life. Prevent damage. Store your hearing aid in a dehumidifier every night.

Best Value DryAid Dehumidifier.....#88742

Larger size makes this hearing aid dehumidifier more powerful. The Super Dri-Aid Kit includes pellets that can be recharged for repeated use.

Super Dri-Aid Kit#88740



For pricing or to order accessories
call 1-800-221-2099 or visit www.HearingHelp.com

Ear care

ProEar by MiraCell helps relieve itchy, irritated ears! MiraCell is a safe, all-natural solution formulated with high-quality plant extracts. Clinically and Dermatologically tested.

MiraCell Ear Solution (1/2 oz).....#88851



Earwax sometimes builds up in ears. Don't use cotton swabs to clean your ears. Safely remove earwax with this handy kit. Kit includes: liquid solution, squeezable bulb syringe and instructions.

Earwax Removal Kit.....#88578



To order accessories

call 1-800-221-2099 or visit www.HearingHelp.com

Limited manufacturer's warranty

What does this warranty cover?

Intricon Inc. ("Intricon") warrants your new product against defects in materials and workmanship when purchased from an authorized reseller.

How long does this warranty last?

This warranty is valid from the date of retail purchase for a period of twelve months. This warranty terminates if you sell or transfer the product.

What will Intricon do?

In the case of a covered warranty defect, Intricon will, at its option: (A) repair the product; or (B) replace the product with an equivalent product.

What does the warranty not cover?

This warranty only extends to the original end-use purchaser or person receiving the product new as a gift. This warranty does not extend to any other person or transferee. This warranty does not cover defects or damage arising from improper use or maintenance, normal wear and tear, commercial use, accident, or external causes. Also, unauthorized repair, modification, or customization of your product voids this warranty. This warranty does not cover the return freight charge.

What do I do?

For warranty service on covered defects during the warranty period, contact us at www.HearingHelpExpress.com, support@hearinghelp.com, 1-800-221-2099, or write to: Hearing Help Express, PO Box 586, DeKalb, IL 60115. Prior to providing warranty service, Intricon may require you to provide proof of purchase details, including but not limited to a receipt or sales invoice.

How does state law apply?

This warranty gives you specific legal rights, and you may also have other rights which vary from state to state.

This limited warranty gives you specific rights that are in addition to other rights you may have under applicable laws, including your rights against the person who sold the Intricon product to you. TO THE EXTENT PERMITTED BY LAW, HOWEVER, THIS WARRANTY IS THE SOLE AND EXCLUSIVE WARRANTY PROVIDED BY INTRICON. INTRICON DISCLAIMS ALL OTHER WARRANTIES WHETHER EXPRESS OR IMPLIED (INCLUDING BUT NOT LIMITED TO ANY WARRANTY OF MERCHANTABILITY, SATISFACTORY QUALITY, FITNESS FOR PARTICULAR PURPOSE, TITLE, AND NON-INFRINGEMENT), AND INTRICON'S LIABILITY SHALL BE LIMITED TO THE ORIGINAL PURCHASE PRICE. FOR ANY IMPLIED WARRANTIES THAT CANNOT BE DISCLAIMED UNDER APPLICABLE LAW, THE TERM OF THE IMPLIED WARRANTIES SHALL BE LIMITED TO THE DURATION OF THE FOREGOING EXPRESS WARRANTY PERIOD.

Warranty

For your records

Complete and retain for your records

Date of purchase: _____

Serial numbers:

Left hearing aid _____

Right hearing aid _____

1B tube and tulip dome come attached to the hearing aids. If you selected a different size for either accessory, then keep record of those sizes for future accessory reordering.

Preferred tube size: _____

Preferred dome style/size: _____

Battery size: 312 (brown) zinc-air hearing aid battery

Questions or concerns?

We're here to help!

Call 1-800-221-2099 (Mon-Fri • 7:30 am - 5:00 pm CT)
or email us at: support@hearinghelp.com



YOUR MONEY-BACK GUARANTEE FROM HEARING HELP EXPRESS®

Your assurance of complete satisfaction

45-Day, Risk-Free Trial Money-Back Guarantee

Try your Hearing Help Express® Apollo®-6205 hearing aid for 45 days risk-free. If you are not 100% satisfied, simply return all materials within 45 days from the date of delivery, and we will refund any money paid towards the purchase price. You are responsible for the safe return of all materials in their original condition. Ship insured mail.



QUALITY YOU CAN TRUST



**HIGH VALUE HEARING
WITH 5-STAR CUSTOMER SUPPORT**



MP010-230314

© Hearing Help Express®, Inc.